

KEY	PART No.	DESCRIPTION	MATERIAL	QTY.
1	300-81-1MJ	BODY	D.I., A536 Gr. 65-45-12	1
2	300-81-2	BONNET	D.I., A536 Gr. 65-45-12	1
3	300-8-4-SCW	STEM	AISI 304 SS	1
4	300-8-5	BONNET CAP	D.I., A536 Gr. 65-45-12	1
5	300-8-6-SCW	WEDGE, CLOSE CLOCKWISE	AL BRZ, B148-954	1
6	300-8-8	DISC	AL BRZ, B148-954	2
7	300-8-9	SEAT	AL BRZ, B505-C95400	2
8	300-6-10-SCW	WRENCH NUT	D.I., A536 Gr. 65-45-12	1
9	300-8-11	BONNET GASKET	GARLOCK STYLE 19	1
10	HHCS.625-11X2.75	HHCS, 5/8-11 UNC x 2.75" LG.	304 SS	12
11	FHN.625-11	STD HEX HD NUT, 5/8"-11 UNC	304 SS	12
12	HHCS.5-13X1.5	HHCS, 1/2-13 UNC x 1.5" LG	304 SS	4
13	FHN.5-13	STD HEX HD NUT, 1/2"-13 UNC	304 SS	1
14	PLG.375	PLUG, HEX HEAD, 3/8" NPTF	CARBON STEEL	1
15	AS568A-232	O-RING SIZE -232	BUNA N DUROMETER 70	1
16	AS568A-216	O-RING SIZE -216	BUNA N DUROMETER 70	3

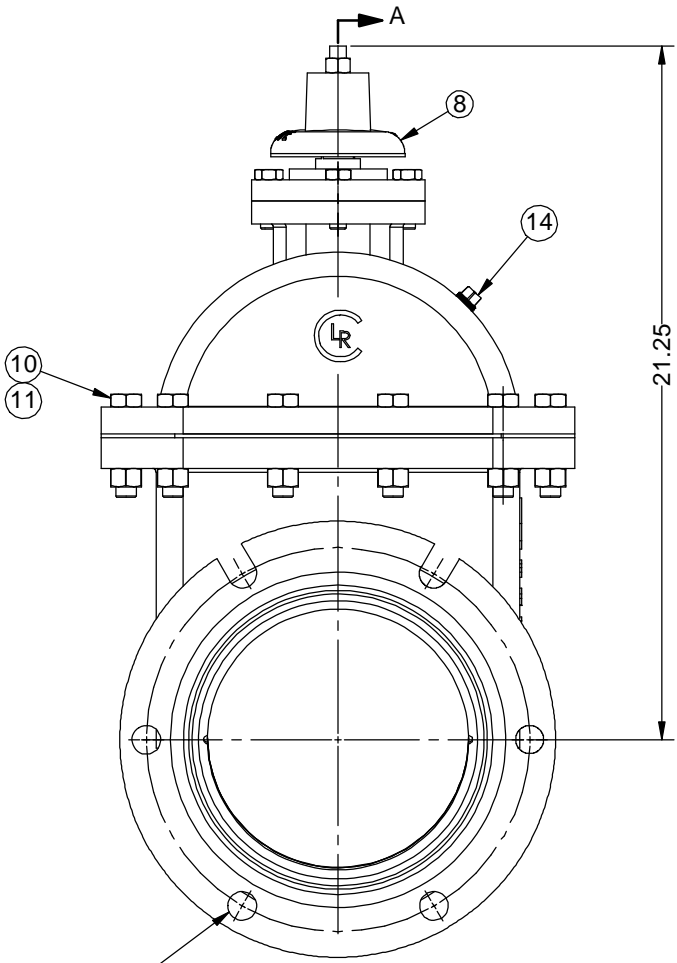

4X ϕ .880 THRU
 2X .880 SLOTS
 ϕ 11.75 BOLT CIRCLE
 BOTH FLANGES

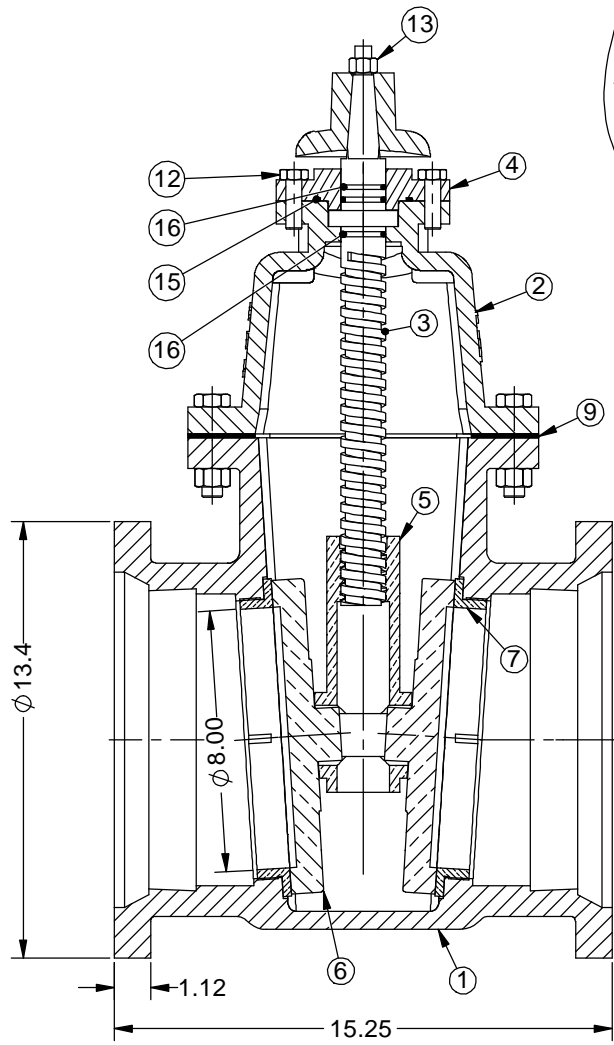

SECTION A-A

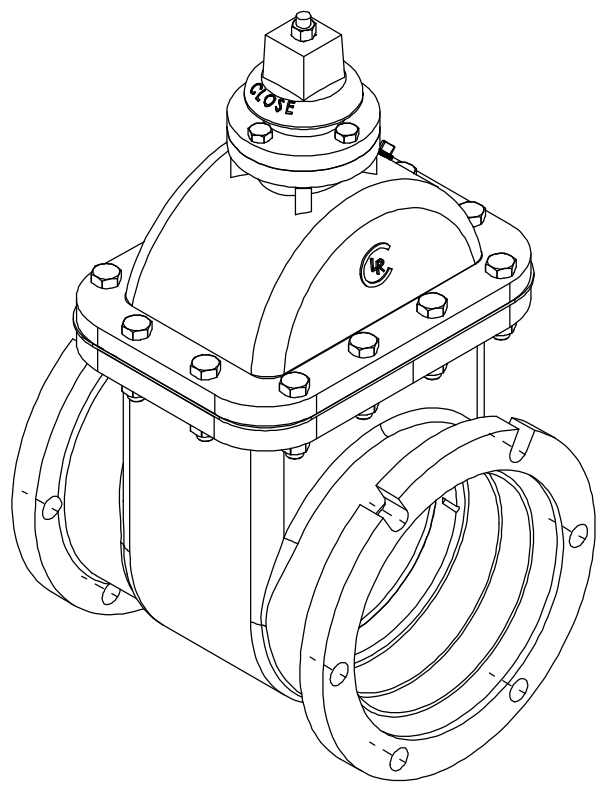

- NOTES:
- 250 PSIG MAX. WORKING PRESSURE
 - 500 PSIG HYDROSTATIC TEST PRESSURE
 - MECHANICAL JOINT ENDS IN ACCORDANCE WITH ANSI/AWWA C111.
 - APPROXIMATE WEIGHT: 271 LBS.
 - VALVE WILL BE COATED INTERNALLY & EXTERNALLY WITH TNEMEC 141 EPOXY, 8-10 MILS DFT.
 - MANUFACTURED IN ACCORDANCE WITH ANSI/AWWA C500, LATEST REVISION.
 - Assy. P/N: LR0861123111129J0CF

REVISIONS			
REV	DESCRIPTION	DATE	APP'D

DRAWN	NAME	DATE	Ludlow-Rensselaer Gate Valves by Crispin Valves		
CHECKED	BBG	05/16/17	8" AWWA C111 MJ, Fig. 306 Gate Valve, w/ 2" Sq. Nut, Close Clockwise		
DIMENSIONS ARE IN INCHES DO NOT SCALE DRAWING			SIZE	DWG. NO.	REV
FILE LOCATION: N:\GateValve\306\			C	9100757	0
SCALE: 0.34:1			WT: 271 LB	SHEET 1 OF 1	