

- NOTES:
1. INLET SIZE: 6" CLASS 150  
OUTLET SIZE: 6 NPT
  2. APPROXIMATE WEIGHT: 215 lbs
  3. VALVE WILL BE COATED EXTERNALLY WITH PHENOLIC ALKYD PRIMER

FLANGE DATA	
FLANGE DIAMETER	11.00 in.
FLANGE THICKNESS	1.00 in.
BOLT CIRCLE DIAMETER	9.50 in.
NUMBER OF BOLT HOLES	8
BOLT HOLE DIAMETER	0.88 in.

ORIFICE DATA	
DIAMETER	MAXIMUM WORKING PRESSURE
5/16	100 PSIG
1/4	150 PSIG
3/16	200 PSIG
5/32	250 PSIG
1/8	300 PSIG

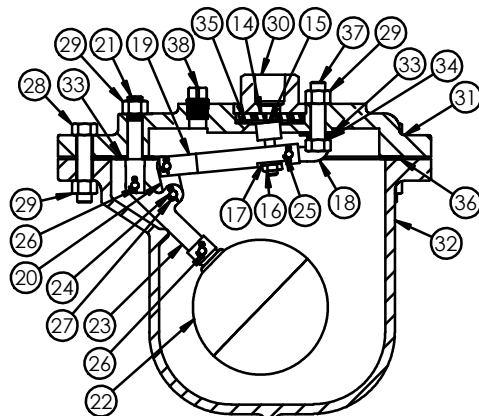

SECTION A-A

REV.	DESCRIPTION	DATE	APPROVED
2	REDRAWN IN SOLIDWORKS	10-25-19	
1	REDRAWN IN AUTOCAD	9-12-18	BJL

PROPRIETARY AND CONFIDENTIAL  
THE INFORMATION CONTAINED IN THIS DRAWING IS THE SOLE PROPERTY OF CRISPIN VALVE. ANY REPRODUCTION IN PART OR AS A WHOLE WITHOUT THE WRITTEN PERMISSION OF CRISPIN VALVE IS PROHIBITED.

UNLESS OTHERWISE SPECIFIED: DIMENSIONS ARE IN INCHES		NAME	DATE
XX DIMENSIONS	±.1	DRAWN	DJF 10-25-19
XXX DIMENSIONS	±.01	CHECKED	- -
XXXX DIMENSIONS	±.005	ENG APPR.	- -
DIMENSIONED HOLES	±.01	MFG APPR.	- -
ANGLES	±.1	Q.A.	- -
CONCENTRIC DIAMETERS	SEE BELOW	FILE LOCATION:	
MACHINED TO CAST	.005 TIR	FILE NAME:	C61_8239045.r2
MACHINED SURFACES	.02 TIR		
BEFORE FINISH	125 RMS		
BREAK SHARP EDGES			
MATERIAL:			
FINISH:			

AIR / VACUUM UNIT PARTS LIST				
ITEM NO.	PART NUMBER	DESCRIPTION	MATERIAL	QTY.
1	60-1S	TOP	CAST IRON	1
2	60-2H	COVER FLANGE	CAST IRON	1
3	60-3F-C	BODY	CAST IRON	1
4	60-4	COVER GASKET	ARMSTRONG	1
5	60-5	SEAT	BUNA-N RUBBER	1
6	60-6	FLOAT	STAINLESS STEEL	1
7	HHCS.5X1.5	TOP BOLT	STEEL	10
8	HHCS.75X3	COVER BOLT	STEEL	8
9	FHN.75-10	COVER NUT	STEEL	10
10	HHCS.75X3.25	LUG BOLT	STEEL	2
11	80-55	LIFTING LUG	STEEL	2
12	PLG.5	BODY PLUG	BRASS	1
PRESSURE UNIT PARTS LIST				
14	13-1N	PRESSURE SEAT	PVC	1
15	13-4N	VALVE PLUNGER	BUNA-N & S/S	1
16	JFHN.25-28	PLUNGER NUT	STAINLESS STEEL	1
17	LW.25	LOCK WASHER	STAINLESS STEEL	1
18	13-5R	VALVE FULCRUM	STAINLESS STEEL	1
19	26-6S	VALVE LEVER	STAINLESS STEEL	1
20	13-7R	LINK	STAINLESS STEEL	2
21	13-8R	FLOAT FULCRUM	STAINLESS STEEL	1
22	26-9R	FLOAT	STAINLESS STEEL	1
23	26-8R	FLOAT LEVER	STAINLESS STEEL	1
24	13-11R	BEARING PIN	STAINLESS STEEL	2
25	13-12R	BEARING PIN	STAINLESS STEEL	1
26	13-11AR	BEARING PIN	STAINLESS STEEL	2
27	18-7A	COTTER PIN	STAINLESS STEEL	5
28	HHCS.375X1.75	COVER BOLT	STEEL	7
29	FHN.38-16	NUT	STEEL	9
30	1-1S	TOP	CAST IRON	1
31	13-20	COVER FLANGE	CAST IRON	1
32	21-1C	BODY	CAST IRON	1
33	13-22	FULCRUM WASHER	FIBER	2
34	13-26	FULCRUM WASHER	FIBER	1
35	13-23	SEAT GASKET	BUNA-N RUBBER	1
36	13-24	COVER GASKET	ARMSTRONG	1
37	HHCS.375X1.5	FULCRUM BOLT	STAINLESS STEEL	1
38	27-29	FLANGE PLUG	BRASS	1
CONNECTING PARTS LIST				
40	21-24	MATING GASKET	ARMSTRONG	1
41	HHCS.5X1.25	MATING BOLT	STEEL	4

**CRISPIN VALVES**

TITLE:  
6" CLASS 125, COMBINATION AIR RELEASE VALVE

SIZE	DWG. NO.	REV
<b>B</b>	C61 8239045	2
SCALE: 0.31:1	WT: LB	SHEET 1 OF 1