

C Series, Combination Air Release Valves, Sizes 1/2"-24", AWWA C512

C Series Combination Air Release Valve, Size 6"-10"*

C SERIES, 6"-10" SIZE MATERIALS LIST

Air & Vacuum Unit

ITEM	DESC.	MATERIAL
1	TOP	Cast Iron
2	COVER FLANGE	Cast Iron
3	COMBO BODY	Cast Iron
4	COVER GASKET	Armstrong
5	AIR/VAC SEAT	Buna-N-Rubber
6	FLOAT	Stainless Steel
7	TOP BOLT	Steel
8	COVER BOLT	Steel
9	COVER NUT	Steel
10	LUG BOLT	Steel
11	LIFTING LUG	Steel
12	BODY PLUG	Brass

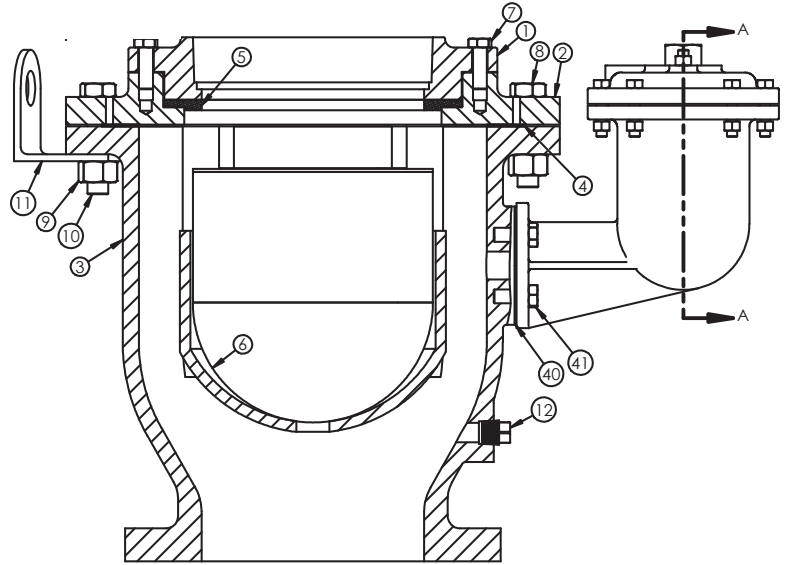

Pressure Air Release Unit

ITEM	DESC.	MATERIAL
14	PRESSURE SEAT	PVC
15	VALVE PLUNGER	Buna-N & Stainless Steel
16	PLUNGER NUT	Stainless Steel
17	LOCK WASHER	Stainless Steel
18	VALVE FULCRUM	Stainless Steel
19	VALVE LEVER	Stainless Steel
20	LINK	Stainless Steel
21	FLOAT FULCRUM	Stainless Steel
22	FLOAT	Stainless Steel
23	FLOAT LEVER	Stainless Steel
24	BEARING PIN	Stainless Steel
25	BEARING PIN	Stainless Steel
26	BEARING PIN	Stainless Steel
27	COTTER PIN	Stainless Steel
28	COVER BOLT	Steel
29	NUT	Steel
30	TOP	Cast Iron
31	COVER FLANGE	Cast Iron
32	BODY	Cast Iron
33	FULCRUM WASHER	Fiber
34	FULCRUM WASHER	Fiber
35	SEAT GASKET	Buna-N-Rubber
36	COVER GASKET	Armstrong
37	FULCRUM BOLT	Stainless Steel
38	FLANGE PLUG	Brass

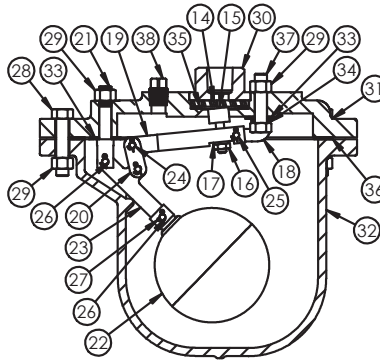

Connecting Parts

ITEM	DESC.	MATERIAL
40	MATING GASKET	Armstrong
41	MATING BOLT	Steel

C Series, 6"-10" Size Specifications

DIMENSIONS ARE IN INCHES. CERTIFIED DIMENSIONS AVAILABLE.

Model	Inlet Size	Outlet Size	Overall Width	Overall Height	Weight (lbs)
**C61	6 125# FLG.	6 NPT	23.03	15.50	196
**C62	6 250# FLG.	6 NPT	23.03	15.84	212
**C81	8 125# FLG.	8 NPT	25.625	18.84	305
**C82	8 250# FLG.	8 NPT	25.625	18.84	327
**C101	10 125# FLG.	10 NPT	30	21.78	571
**C102	10 250# FLG.	10 NPT	30	22.50	607

**Includes ANSI CL. 125 or 250 Companion Flange & Nipple

*** FOR SIZES ABOVE 10", PLEASE CONTACT THE FACTORY.**



PRODUCT LINE

C Series Combo. Air Release Valves, 1/2"-24

SHEET

C Series Materials List, sizes 6-10"

DATE

8/30/2023

REVISION

0

DOC. NO.

D-AV-C-6-10-ML-r0