

Dimensional Data and Materials List, 3"-24" SC Series Surge Check Valve

SC SERIES: MODEL INFORMATION AND DIMENSIONS

Installations Where a Surge Check Valve Is Strongly Recommended:

- ✓ If system line velocities are near or exceed 10fps
- ✓ If the installation has a control and/or check valve down stream of the air release valve
- ✓ If the potential for surge exists because of piping configurations (valve at the high point in a system with very steep or vertical slopes on either side and moderate flow velocity.)
- ✓ If conditions exist for an increase in flow velocity due to addition of an alternate source.

Crispin Surge Check Valves are installed on the inlet of Crispin Air & Vacuum, Dual, Deep Well, Combination and Universal Valves to permit the float or valve to seat without the influence of surge.

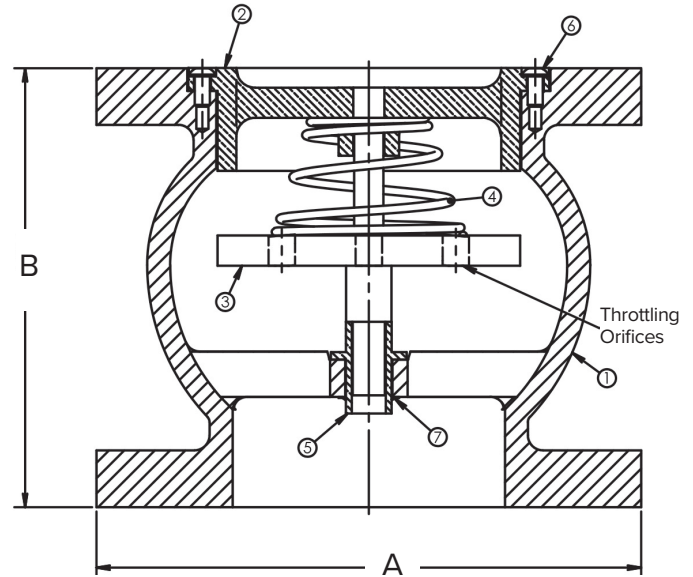

SC Series, 3"-24"* Size Specifications

DIMENSIONS ARE IN INCHES. CERTIFIED DIMENSIONS AVAILABLE.

Model	Inlet Size	Outlet Size	Width (A)	Height (B)	Weight (lbs)
SC31	3 CL 150	3 CL 150	7.50	6.00	23
SC33	3 CL 300	3 CL 300	8.25	6.01	32
SC41	4 CL 150	4 CL 150	9	7.25	38
SC43	4 CL 300	4 CL 300	10	7.26	49
SC61	6 CL 150	6 CL 150	11	9.75	72
SC63	6 CL 300	6 CL 300	12.50	9.76	101
SC81	8 CL 150	8 CL 150	13.62	12.51	126
SC83	8 CL 300	8 CL 300	15	12.51	174
SC101	10 CL 150	10 CL 150	16.87	15.51	185
SC103	10 CL 300	10 CL 300	17.50	15.51	275
SC121	12 CL 150	12 CL 150	20.63	14.26	308
SC123	12 CL 300	12 CL 300	20.50	14.26	389
SC141	14 CL 150	14 CL 150	22.50	15.75	380
SC 143	14 CL 300	14 CL 300	23	15.75	441
SC161	16 CL 150	16 CL 150	23.50	17.63	525
SC163	16 CL 300	16 CL 300	26.41	17.63	658
SC201	20 CL 150	20 CL 150	31.25	20.63	815
SC203	20 CL 300	20 CL 300	31.25	20.63	1061

* For 24" size specifications, please contact the factory.

SC Series Materials List

ITEM	DESC.	MATERIAL
1	BODY	Ductile Iron (ASTM A536)
2	SEAT RING	316 Stainless Steel
3	DISC	316 Stainless Steel
4	SPRING	Stainless Steel (ASTM A313)
5	BUSHING	316 Stainless Steel
6	SCREW	Stainless Steel (ASTM A193-B8M)
7	RETAINING RING	Stainless Steel (PH15-7 MO)



PRODUCT LINE
SC Series Surge Check Valve, 3"-24"

DATE
12/18/2023

REVISION
0

SHEET
SC Series Dimensions and Materials List

DOC. NO.
D-AV-SC-DIMS+ML-r0