

# Materials List/Dimensional Data for Air & Vacuum UX Series, AWWA C-512, 1"-6"

## UX SERIES: SIZES 1-6" AVAILABLE

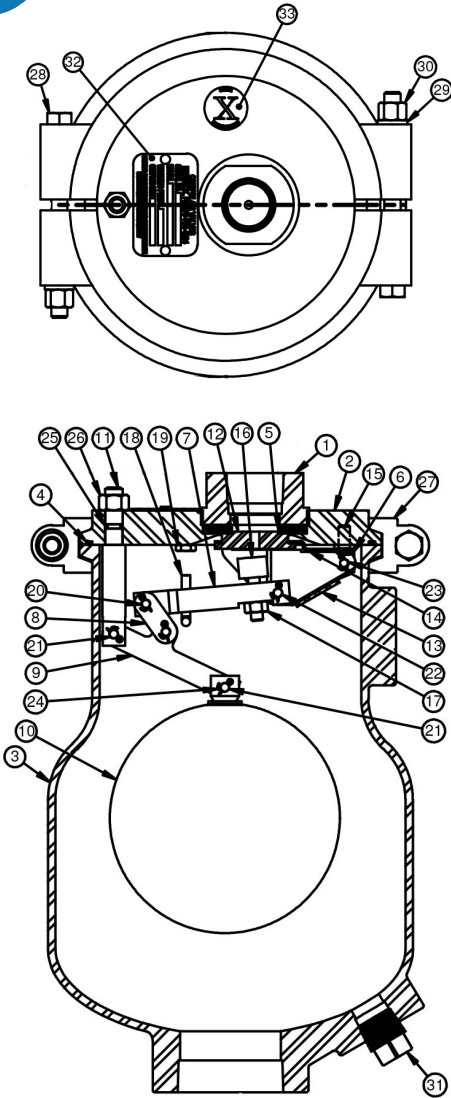

### Universal Combination Assembly for Water & Wastewater Applications



#### PARTS LIST

ITEM	DESCRIPTION	MATERIAL	QTY
1	TOP	316 Stainless Steel	1
2	COVER FLANGE	316 Stainless Steel	1
3	BODY	ASTM A351 GR CF8M	1
4	FLANGE O-RING	Buna-N Rubber	1
5	SEAT	Buna-N Rubber	1
6	LEVER FULCRUM	316 Stainless Steel	2
7	VALVE LEVER	316 Stainless Steel	1
8	LINK	316 Stainless Steel	2
9	BALL LEVER	316 Stainless Steel	1
10	FLOAT	316 Stainless Steel	1
11	BALL FULCRUM	316 Stainless Steel	1
12	PRESSURE SEAT	316 Stainless Steel	1
13	PRES. FULCRUM	316 Stainless Steel	1
14	SEAT CAGE	316 Stainless Steel	1
15	FULCRUM SCREW	316 Stainless Steel	2
16	VALVE PLUNGER	Buna-N/316 SS	1
17	PLUNGER NUT	316 Stainless Steel	1
18	LIMIT STOP	316 Stainless Steel	1
19	LIMIT STOP NUT	316 Stainless Steel	1
20	BEARING PIN	316 Stainless Steel	2
21	BEARING PIN	316 Stainless Steel	2
22	BEARING PIN	316 Stainless Steel	1
23	BEARING PIN	316 Stainless Steel	1
24	COTTER PIN	316 Stainless Steel	6
25	FULCRUM O-RING	Buna-N Rubber	1
26	FULCRUM NUT	316 Stainless Steel	1
27	CLAMP HALF	ASTM A351 GR CF8M	2
28	CLAMP BOLT	316 Stainless Steel	2
29	LOCKWASHER	316 Stainless Steel	2
30	CLAMP NUT	316 Stainless Steel	2
31	PLUG	316 Stainless Steel	1
32	TAG	316 Stainless Steel	1
33	BLUE DOT	Aluminum	1

#### ORIFICE DATA

MODEL	ORIFICE DIAMETER	STAND. OPERATING PRESSURE
UX20	3/16"	20-200psi
UX20-2	3/16"	20-200psi
UX31	5/32"	20-150psi
UX41	5/32"	20-150psi
UX61	5/32"	20-150psi

#### SIZING AND SPECIFICATIONS

MODEL	SIZE"	INLET"	OUTLET"	H"	W"	WTlb
UX20	2	2 NPT	1 NPT	13.50	8.38	30
UX21	2	2 CL150	1 NPT	16.50	8.38	32
UX20-2	2	2 NPT	2 NPT	13.63	11.00	35
UX21-2	2	2 CL150	2 NPT	16.63	11.00	40
UX30	3	3 NPT	3 NPT	21.13	13.25	95
UX31	3	3 CL50	3 NPT	21.63	13.25	102
UX40	4	4 NPT	4 NPT	22.13	13.25	105
UX41	4	4 CL150	4 NPT	22.75	13.25	115
UX61	6	6 CL150	6 NPT	26.88	13.25	143

Certified Dimensions Available Upon Request.



<b>PRODUCT LINE</b> X Series 316 SS Air Valve, Sizes 2"-6"	<b>DATE</b> 12/6/22	<b>REVISION</b> 0
<b>SHEET</b> Materials List/Dimensions for UX Assembly	<b>DOC. NO.</b> DW-AV-UX-ML+DIMS-r0	