

8 7 6 5 4 3 2 1

PARTS LIST				
ITEM NO.	PART NUMBER	DESCRIPTION	MATERIAL	QTY.
1	606-1FH	BODY	DUCTILE IRON	1
2	606-2R	RESILIENT SEAT RING	BUNA-N & AL-BRZ	1
3	606-3	DISC	AL-BRONZE	1
4	606-4	SPRING	STAINLESS STEEL	1
5	606-5	BUSHING	AL-BRONZE	1
6	BHCS.25X.50	SCREW	STAINLESS STEEL	2
7	606-8	RETAINING RING	STAINLESS STEEL	1
8	606-30	SHAFT	AL-BRONZE	1

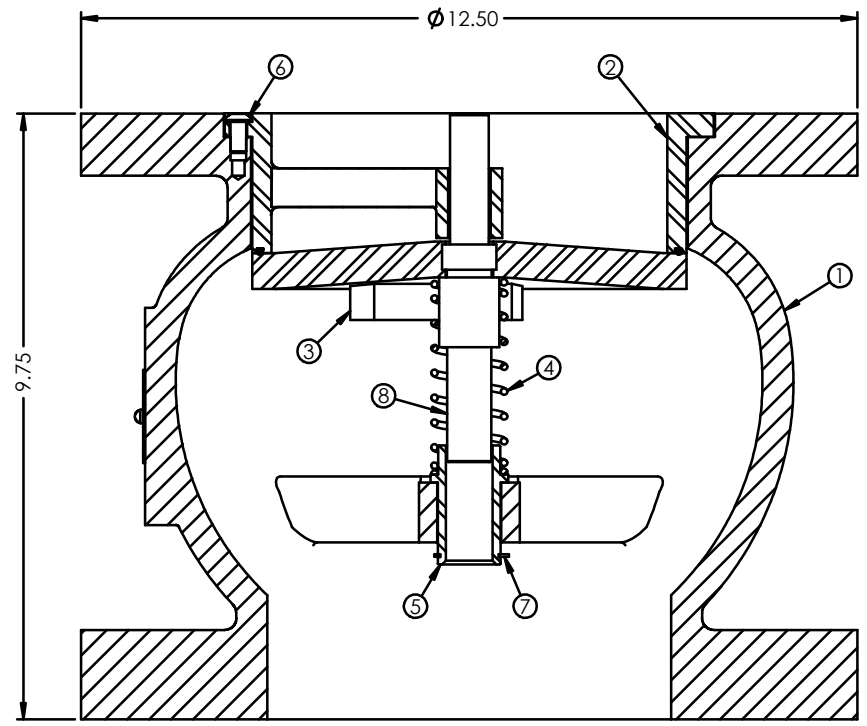

FLANGE DATA	
FLANGE DIAMETER	12.50 in.
FLANGE THICKNESS	1.44 in.
BOLT CIRCLE DIAMETER	10.62 in.
NUMBER OF BOLT HOLES	12
BOLT HOLE DIAMETER	0.88 in.

- NOTES:**
- INLET SIZE: 6" CL. 300 FLANGED  
OUTLET SIZE: 6" CL. 300 FLANGED
  - APPROXIMATE WEIGHT: 101 lbs
  - VALVE WILL BE COATED EXTERNALLY WITH PHENOLIC ALKYD PRIMER

REV.	DESCRIPTION	DATE	APPROVED
1	REDRAWN IN SOLIDWORKS	10-5-21	BJL

REVISIONS			TITLE:
NAME	DATE		
DRAWN	DJF	10-5-21	<b>CRISPIN VALVES</b> 6" CL. 300 RESILIENT SEAT GLOBE CHECK VALVE
CHECKED	-	-	
ENG APPR.	-	-	
MFG APPR.	-	-	
Q.A.	-	-	

UNLESS OTHERWISE SPECIFIED:	
DIMENSIONS ARE IN INCHES	
XX DIMENSIONS	±.1
XXX DIMENSIONS	±.01
XXXX DIMENSIONS	±.005
DRILLED HOLES	±.01
ANGLES	±1°
CONCENTRIC DIAMETERS	SEE BELOW
MACHINED	005 TIR
MACHINED TO CAST	02 TIR
MACHINED SURFACES	125 BMS
REMOVE CHAMFERS	
BREAK SHARP EDGES	

PROPRIETARY AND CONFIDENTIAL  
 THE INFORMATION CONTAINED IN THIS DRAWING IS THE SOLE PROPERTY OF CRISPIN VALVE. ANY REPRODUCTION IN PART OR AS A WHOLE WITHOUT THE WRITTEN PERMISSION OF CRISPIN VALVE IS PROHIBITED.

MATERIAL:	PER BOM
FINISH:	

FILE LOCATION:  
 \\S2\51\Drawings\ASSEMBLY\GC\  
 FILE NAME: GC63.R 8280425 r1

SIZE	DWG. NO.	REV
<b>B</b>	GC63.R 8280425	1
SCALE: 0.5:1	WT: LB	SHEET 1 OF 1

8 7 6 5 4 3 2 1