

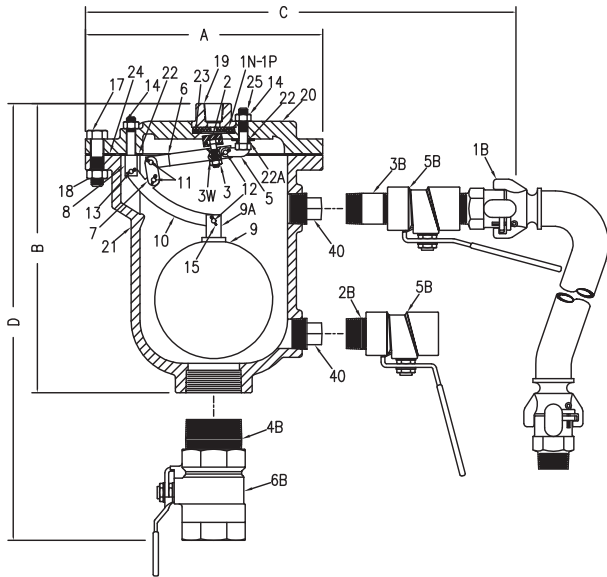

S SERIES

Pressure Sewer Valve



Parts List

PART #	ITEM	MATERIAL
*1N	Seat	PVC
*1P	Seat	Stainless Steel
2	Valve Plunger	Buna-N Rubber & S/S
3	Plunger Nut	Stainless Steel
3W	Lock Washer	Stainless Steel
5	Valve Fulcrum	Stainless Steel
6	Valve Lever	Stainless Steel
7	Link	Stainless Steel
8	Ball Fulcrum	Stainless Steel
9	Ball Float	Stainless Steel
9A	Float Rod	Stainless Steel
10	Ball Lever	Stainless Steel
11	Bearing Pin	Stainless Steel
12	Bearing Pin	Stainless Steel
13	Bearing Pin	Stainless Steel
14	Nut	Steel
15	Cotter Pin	Stainless Steel
17	Bolt	Steel
18	Nut	Steel
19	Top	Cast Iron
20	Flange	Cast Iron
21	Body	Cast Iron
22	Fulcrum Washer	Fibre
22A	Fulcrum Washer	Fibre
23	Seat Gasket	Buna-N Rubber
24	Flange Gasket	Armstrong N-8092
25	Bolt	Stainless Steel
40	Flush Plug	Cast Iron
*1B	Hose Assembly	Cad. Plt. Steel & Rubber
*2B	Nipple	Steel
*3B	Nipple	Steel
*4B	Nipple	Steel
*5B	Ball Valve	Brass
*6B	Ball Valve	Brass

Short Pressure Sewer Series

MODEL	INLET	OUTLET	HEIGHT
S20S	2" screwed	1/2" screwed	12 1/2"
S20SB	2" screwed	1/2" screwed	16 1/2"

The CRISPIN Short Sewer Air Release Valve offers the same function as both the Standard Air and Vacuum and Pressure Air Release Sewer Valves.

The shorter height allows the valve to be used where height restrictions are a problem.

*All Crispin valves are hydrostatically tested at 150% of their maximum working pressure. For ease of maintenance, some of the parts are provided as kits or assemblies.

Backflush is optional at customer's request.
Flush plugs are used when a backflush is not requested.

High Capacity Series

Model	Inlet NPT	Orifice	Height	Width	Height w/Back Flush	Width w/Back Flush	Wt.	Wt. w/Back Flush
S20	2" NPT	1/2"	25 1/2"	10 1/16"	29 1/4"	13 3/4"	93	105
S21	2" 125# Flg.	1/2"	26 7/16"	10 1/16"	34 1/4"	13 3/4"	106	136
S30	3" NPT	1/2"	25 1/2"	10 1/16"	31 1/4"	13 3/4"	95	117
S31	3" 125# Flg.	1/2"	27 3/16"	10 1/16"	35 3/16"	13 3/4"	110	163
S40	4" NPT	1/2"	25 1/2"	10 1/16"	31 1/2"	13 3/4"	95	126
S41	4" 125# Flg.	1/2"	27 3/8"	10 1/16"	36 3/8"	13 3/4"	116	193
S61	6" 125# Flg.	1/2"	27 7/16"	10 1/16"	37 15/16"	13 3/4"	125	258