

PARTS LIST

| ITEM NO. | DWG. NO. | DISCRIPTION | MATERIAL | QTY. |
|----------|--------------|------------------------------------|------------------------------------|------|
| 1 | TD36-1A | OUTLET BODY | A126 CL. B CAST IRON | 1 |
| 2 | TD36-1B | INLET BODY | A126 CL. B CAST IRON | 1 |
| 3 | TD36-2 | BODY SEAT O-RING | B584 C95400 ALUMINUM BRONZE | 1 |
| 4 | TD36-2A | BODY SEAT O-RING | D2000 BUNA-N RUBBER | 1 |
| 5 | TD36-3 | DISC | A538 GR.65-45-12 DUCTILE IRON | 1 |
| 6 | TD36-3A | DISC | A582 TYPE 303 STAINLESS STEEL | 2 |
| 7 | TD36-3AT | DISC SEAT RING | B584 C95500 ALUMINUM BRONZE | 1 |
| 8 | TD36-4 | BODY O-RING | D2000 BUNA-N RUBBER | 1 |
| 9 | TD36-5 | DISC BUSHING | B505 C95400 ALUMINUM BRONZE | 2 |
| 10 | TD36-7A | PIVOT PIN | B505 C95500 ALUMINUM BRONZE | 1 |
| 11 | TD36-7B | PIVOT PIN B | B505 C95500 ALUMINUM BRONZE | 1 |
| 12 | 36-8A | TOP HAND HOLE COVER | A126 CL. B CAST IRON | 1 |
| 14 | TD24-8B | BOTTOM HAND HOLE COVER | A126 CL. B CAST IRON | 1 |
| 15 | TD36-9 | COVER BOLT | A307 GR. B CARBON STEEL | 16 |
| 16 | TD36-11 | BODY BOLT | A307 GR. B CARBON STEEL | 16 |
| 17 | TD36-11A | LONG BODY STUD | A108 GR.1035 CARBON STEEL | 22 |
| 18 | TD36-11B | SHORT BODY STUD (BEHIND PIVOT PIN) | A108 GR.1035 CARBON STEEL | 2 |
| 19 | TD36-12A | END BEARING CAP A | A126 CL. B CAST IRON | 1 |
| 20 | TD36-12B | END BEARING CAP B | A126 CL. B CAST IRON | 1 |
| 21 | TD36-15 | DRIVE PLATE ASSEMBLY | B505 C95400 ALUMINUM BRONZE | 1 |
| 22 | TD36-16 | INDICATOR ROD | B505 C95400 ALUMINUM BRONZE | 1 |
| 23 | TD36-23 | BODY DOWEL PIN | A108 GR. 1035 CARBON STEEL | 2 |
| 24 | TD24-14 | END CAP BOLT | A307 GR. B CARBON STEEL | 12 |
| 25 | TD48-16A | INDICATOR ROD COLLAR | A582 TYPE 303 STAINLESS STEEL | 1 |
| 26 | TD48-18 | INDICATOR POINTER | B62 BRONZE | 1 |
| 27 | 2424-12 | BODY NUT | A563 GR. A HEAVY HEX. CARBON STEEL | 40 |
| 28 | 1650 | GREASE FITTING | ALEMITE No. 1650 | 2 |
| 29 | SHSS .31X.38 | INDICATOR SET SCREW | 18-8 STAINLESS STEEL | 1 |
| 30 | PLG-1 | 1" PIPE PLUG | A126 CL. B CAST IRON | 1 |
| 31 | AS 568A-208 | INDICATOR O-RING | D2000 BUNA-N RUBBER | 2 |
| 32 | AS 568A-340 | END CAP O-RING | D2000 BUNA-N RUBBER | 2 |
| 33 | AS 568A-350 | PIVOT PIN O-RING | D2000 BUNA-N RUBBER | 4 |
| 34 | AS 568A-375 | BOTTOM COVER O-RING | D2000 BUNA-N RUBBER | 1 |
| 35 | AS 568A-378 | TOP COVER O-RING | D2000 BUNA-N RUBBER | 1 |

FLANGE DATA

| | |
|----------------------|-----------|
| FLANGE DIAMETER | 46.00 in. |
| FLANGE THICKNESS | 2.38 in. |
| BOLT CIRCLE DIAMETER | 42.75 in. |
| NUMBER OF BOLT HOLES | 32 |
| BOLT HOLE DIAMETER | 1.62 in. |

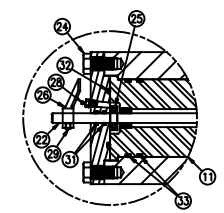

DETAIL A
SCALE 0.25 = 1.00

- NOTES:
 1. 150 PSIG MAXIMUM WORKING PRESSURE.
 2. APPROXIMATE WEIGHT: 7950 LBS.
 3. COATED INTERNALLY AND EXTERNALLY WITH THEMEC SERIES 140 POTA-POX PLUS.

Crispin Valves
 36" CLASS 125 TILTING
 DISC CHECK VALVE

| REV | DESCRIPTION | DATE | APPROVED | DESIGNED | DATE | SIZE | DWG NO | SHEET | OF |
|-----|-------------|------|----------|----------|--------|-------------------|--------|-------|----|
| | | | | B.J.L | | D | TD361 | 0 | |
| | | | | D.J.F | 8-7-40 | SCALE 0.15 = 1.00 | | 1 | 1 |